

HS-502A-HD-EL Technical Data Sheet

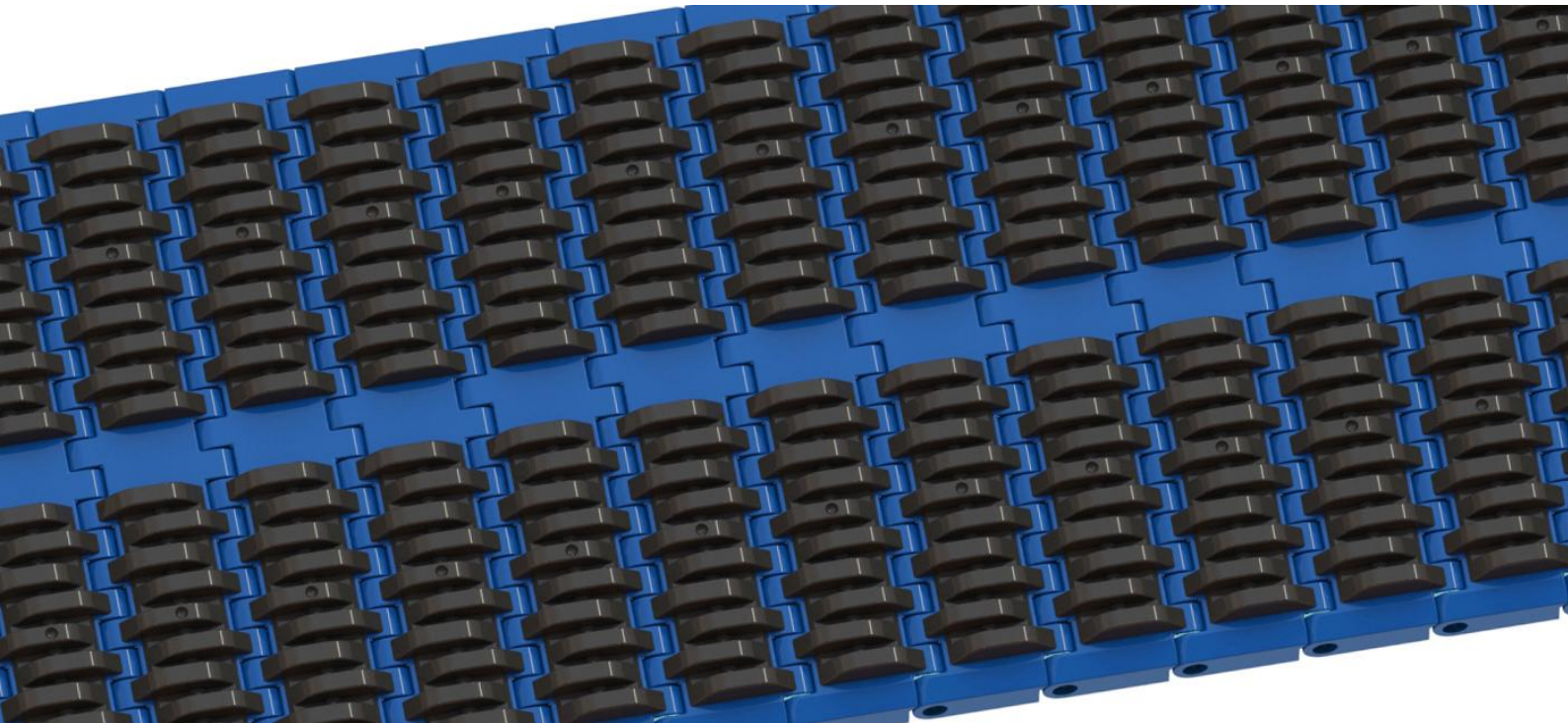

<p>Pitch: 25.4mm Minimum Width: 76mm Open Area: 0% Approved: FDA Rod: Ø 4.9mm Flight: Yes Side Guard: No Curve : No Standard Rubber Indent: 7mm, 14.4mm</p>	
---	--

Data

Belt Material	Belt Strength			Temperature		Belt Weight
	Straight		Curve	°C (min.)	°C (max.)	(Kg/M ²)
	Kg/M(BW)	N/M(BW)				
Polypropylene	2000	20000	--	1	100	6.0

BW – Belt Width

Color Table

Polypropylene					Polyethylene					Acetal					Nylon				
W	G	N	DB	B	W	G	N	DB	B	W	G	N	DB	B	W	G	N	DB	B
●	●		●	●															

W-White, G-Gray, N-Nature, DB-Dark brown, B-Blue

Friction Table

Belt Material	Friction Wear strips & Products							
	UHMW	HDPE	Steel	Glass	SUS	Plastic	Cardboard	Aluminum
Polypropylene	0.32	0.24	0.15	0.09	0.13	0.08	0.15	0.25
Polyethylene	0.13	0.11	0.26	0.19	0.31	0.16	0.21	0.41
Acetal	0.11	0.09	0.27	0.16	0.26	0.15	0.19	0.28
Nylon	0.18	0.13	0.25	0.16	0.26	0.16	0.19	0.27

SUS – Stainless Steel

Equivalent type with other Brand

Brand Name	Intralox	UNI	Rexnord	MCC	Habasit	KVP
Series & Type	--	QNB-C	--	--	--	--

The above content is only for reference.

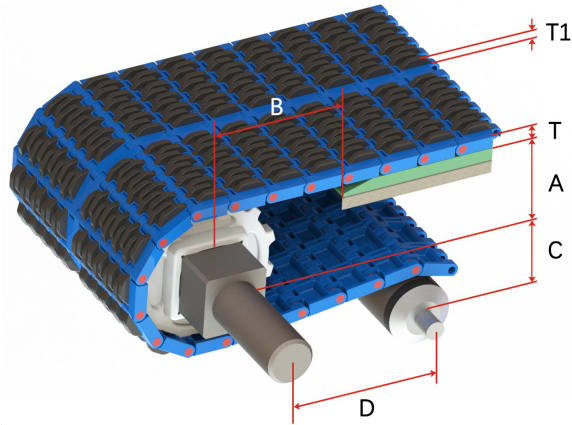

Conveyor Frame Dimensions

Unit : mm

No. Teeth	A (Min.)	B (Min.)	C (Max.)	D (Min.)	T	T1
10	35.6	50	35.2	200	8.8	4.5
12 / 12-Split	43.95	58.35	43.55	200		
15 / 15-Split	56.25	70.65	55.85	200		
18 / 18-Split	68.6	83	68.2	200		
19-Split	72.85	87.25	72.45	200		
24-Split	92.6	107	92.2	250		

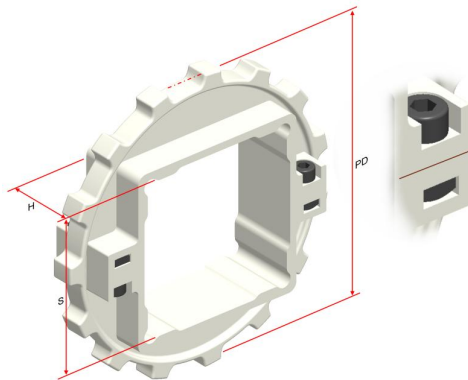

Sprocket Dimensions

Unit: mm

No. Teeth	OD	PD	S	D	H	K
10	80	82	--	25.2	25	8X8
12	96.7	98	38.5/40.5	25.4/38.1/40.5	25	8X8
12-Split	96.7	98	38.5/40.5	38.1	25	9.52X4.76
15	121.3	122	38.2/40.2/50.2/60.2/63.5	25.5/35.5/40.5/50.2	29.5	8X8
15-Split	121.3	122	38.5/40.5/50.5/60.5/63.5/65.5	--	33	--
18	146	146	38.5/40.5/45.5/50.5/60.5	25.4/50.2	25	14X4
18-Split	146	146	38.5/40.5/60.5	50.8	35	14X5
19-Split	154.5	154	38.5/40.5/50.5/60.5/65.5	--	35	--
24-Split	194	195	60.5/65.5	--	52	--