

HS-1701TAB SERIES



Materials



Sprockets



Applications

Plate Materials: POM-DP,POM-LF

Pin Material: Cold rolled austenitic stainless steel

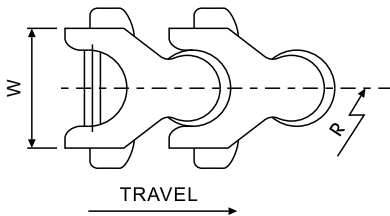
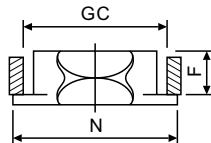
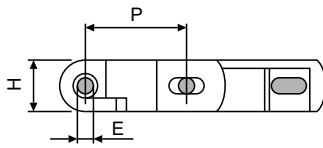

Dimension	mm	inches
P	50.0	1.969
R	150.0	5.906
W	53.2	2.094
H	25.0	0.984
N	66.7	2.626
F	19.0	0.748
E	8.0	0.315
GC(Straight)	57.5	2.264
GC(Curve)	56.0	2.205

HS-1701TAB (Side Flexing Keel Chains)

CHARACTERISTICS

	Width W		Working Load		Radius		Reverse Radius		Weight (kg/m)
	(mm)	(inch)	N(21°C)	lbs(21°C)	(mm)	(inch)	(mm)	(inch)	
HS-1701TAB	53.2	2.09	2669	600	150	5.9	50	1.97	1.49